

# ÜBERSICHTSZEICHNUNG

## ASSEMBLY DRAWING

**GHOST**

*LECTOR SF*



*LECTOR SF ESSENTIAL*



*LECTOR SF UNIVERSAL*



*LECTOR SF ADVANCED*



*LECTOR SF WORLD CUP REPLICA*



## LECTOR SF (MY22)

Datum: 28-10-2021

Version: 01



LECTOR SF (MY22)

date: 28-10-2021

version: 01

page 1 / 4

# ÜBERSICHTSZEICHNUNG

## ASSEMBLY DRAWING

# GHOST

**Hinweis:** Für Modelle ohne integrierte Sattelstütze.

**Note:** For models without integrated seat post.

**Hinweis:** Bei den Schrauben muss mittelfeste Gewindesicherung verwendet werden.  
Rote Flächen müssen gefettet werden.

**Note:** use medium strength screw lock for screw threads.  
red surfaces has to be greased.

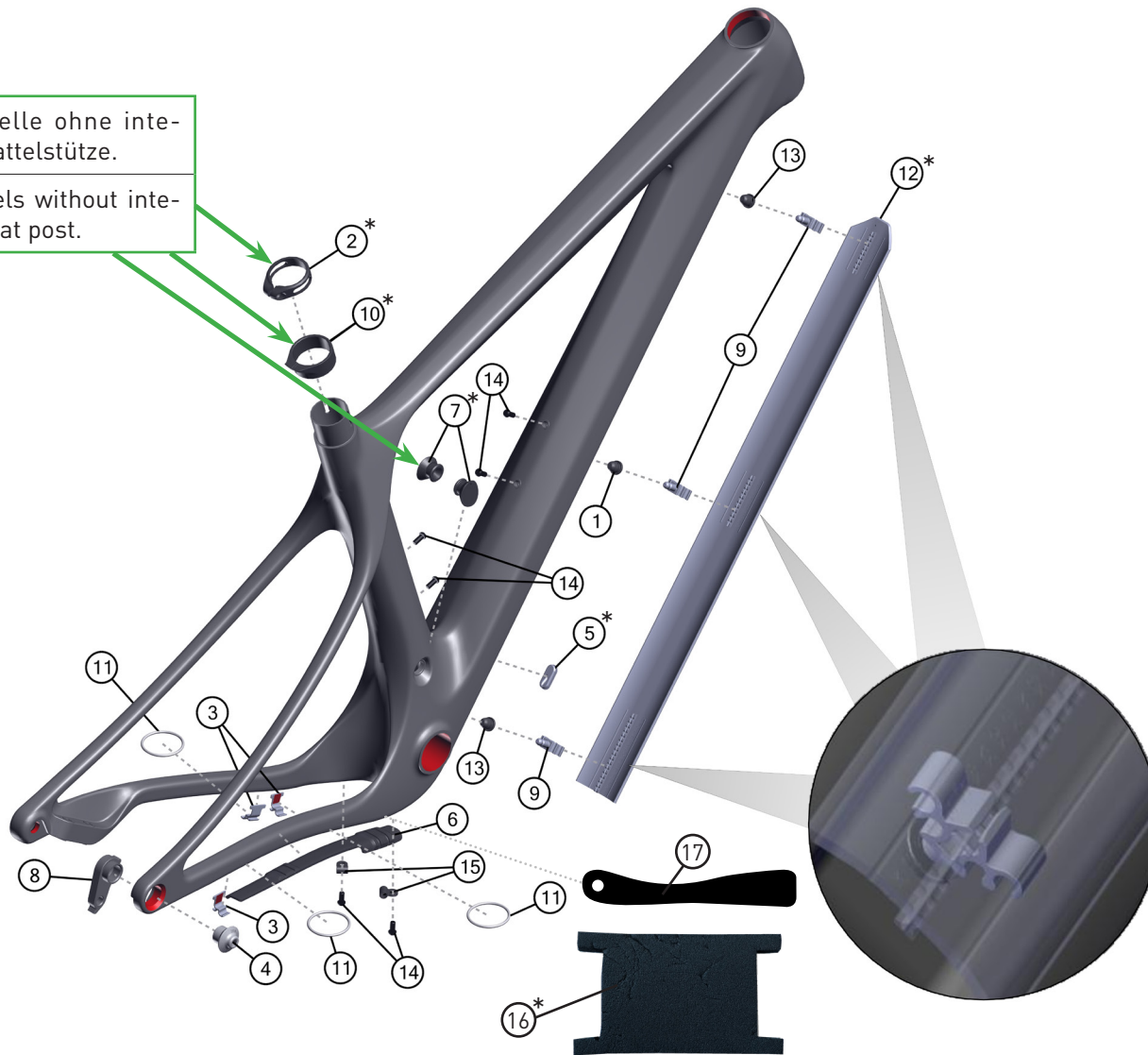

# ÜBERSICHTSZEICHNUNG

## ASSEMBLY DRAWING

# GHOST

BOM-ID	Description	Specification	Torque	Item no.	QTY
1	Snaploc-Coupling 80 Shore			FROT0044	1
2*	GW Seatclamp Style A 38,0mm black		5 Nm	SC0003	1
3	Hesling Chain Stay Cable Holder			FROT0068	3
4	Jovial Nirvana/Lector/Riot Hanger mount T6, black		20 Nm	FRNT0008	1
5*	Winnig Cable Guide Plug 4,5 mm for <b>Eightpins Cable</b>			FROT0074	1
6	Chainstay protector CG, Lector			FRPR0036	1
7*	PP Rubber Plug SET CG, Lector			FRPR0038	1
8	Jovial Nirvana/Lector/Riot Hanger, black			FRHG0025	1
9	Hesling Cable Clip, Lector			FROT0075	3
10*	Rubber ring for Seattube CG, Lector			FRPR0037	1
11	O-Ring Ø 40 x 2,5			FROT0070	3
12*	Downtube Cover, Lector <b>framesize XS - S</b>			FRPR0033	1
12*	Downtube Cover, Lector <b>framesize M</b>			FRPR0034	1
12*	Downtube Cover, Lector <b>framesize L - XL</b>			FRPR0035	1
13	Snaploc-Coupling 93 Shore			FROT0095	2
14	Lens head screw	TX25 - M5 x 12 mm	5 Nm	SM0919	6
15	Cable guide			SM0002	2
16*	BB Intube Staub Schutz for <b>Eightpins</b>			FROT0071	1
17	C/S protector CG down side, Lector			FRPR0051	1

# ÜBERSICHTSZEICHNUNG

## ASSEMBLY DRAWING

# GHOST

FACT SHEET:	
SHOCK LENGTH:	-----
SHOCK HARDWARE TOP:	-----
SHOCK HARDWARE BOTTOM:	-----
HEADSET TOP:	ZS 44
HEADSET BOTTOM:	ZS 56
SEATPOST DIAMETER:	34,9 MM
CLAMP INNER DIAMETER:	38,0 MM
BOTTOM BRACKET:	Pressfit DUB
KICKSTAND:	-----
ISCG STANDARD:	-----
CARRIER MOUNT:	-----
FENDER COMPATIBLE:	-----

DROPPER SEATPOST READY:	YES
WATERBOTTLE MOUNT:	Size XS: 1 x 0,75 L Size S: 1 x 0,5 L + 1 x 0,75 L Size M / L / XL: 2 x 0,75 L
MAXIMUM PERMISSIBLE TOTAL WEIGHT:	120 KG
MAXIMUM TIRE SIZE:	29" x 2.35"
WHEEL SIZE:	29"
QUICK RELEASE LENGTH:	169 MM
OVER-LOCKNUT DIMENSION (O.L.D.):	148 MM
FD CLAMP SIZE:	-----
FD TYPE:	-----
ENGINE:	-----
BATTERY:	-----
DISPLAY:	-----